

T-6 CLASS OPTIMUM RACE PATH

CRITERIA

250 MPH • 3.0 G's

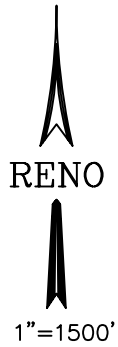

LEGEND

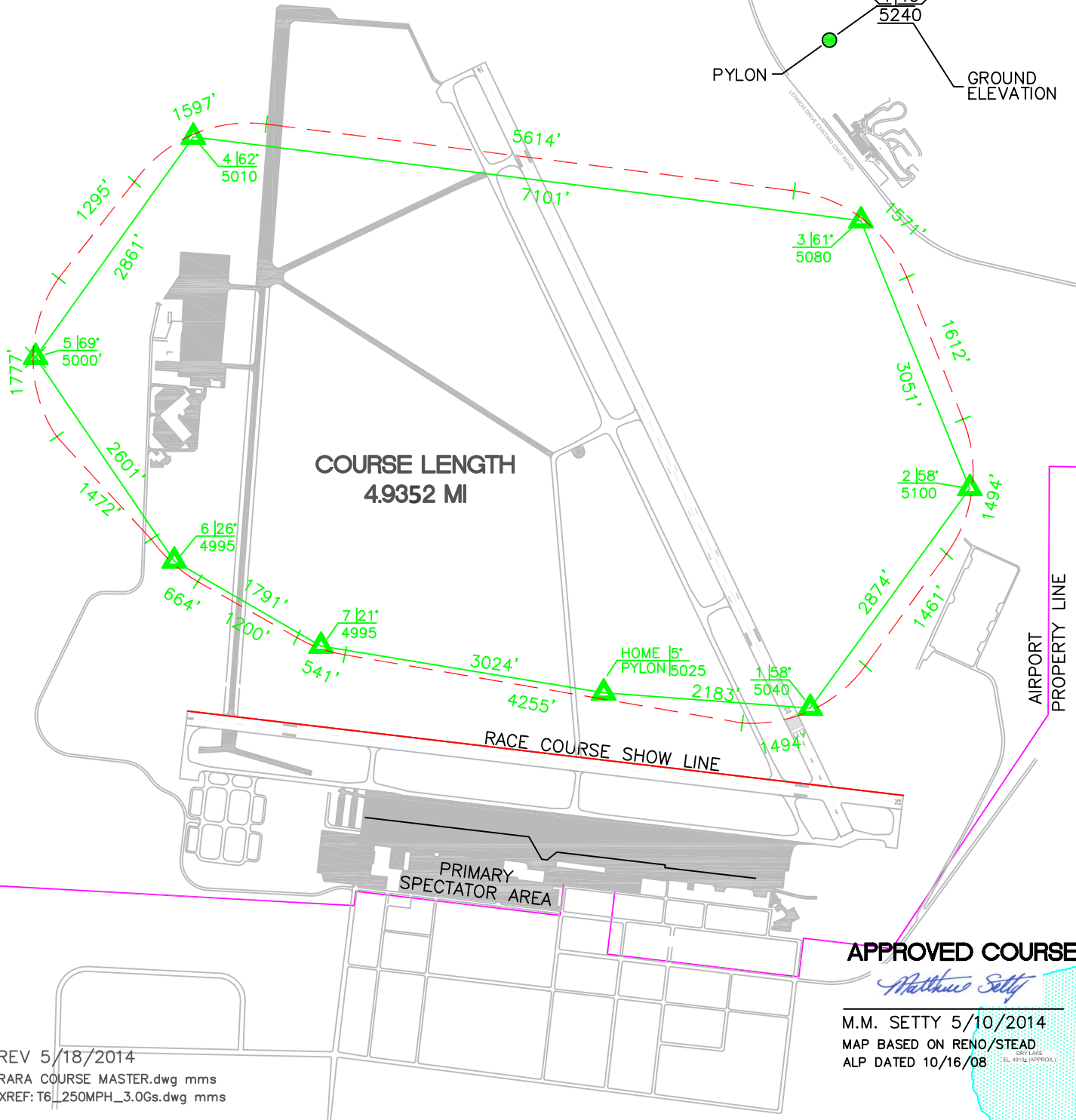
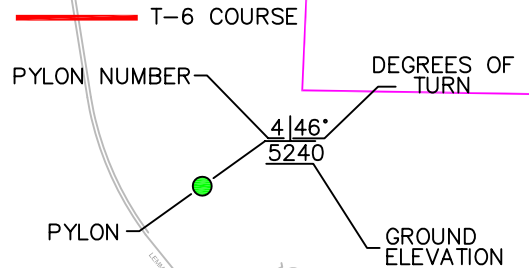

REV 5/18/2014
RARA COURSE MASTER.dwg mms
XREF: T6_250MPH_3.0Gs.dwg mms

2014 OPTIMUM RACE PATH

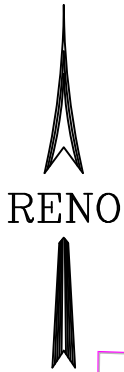

- - - - - **FORMULA ONE COURSE**
3.1875 MILES
- - - - - **BIPLANE COURSE**
3.3417 MILES
- - - - - **T-6 COURSE**
4.9352 MILES

- - - - - **UNLIMITED COURSE**
8.0851 MILES
Start Lap = 7.5888 MILES

- - - - - **JET COURSE**
8.1025 MILES
Start Lap = 7.6113 MILES

- - - - - **SPORT GOLD COURSE**
8.0782 MILES
Start Lap = 7.5934 MILES

- - - - - **SPORT COURSE**
6.9680 MILES
Start Lap = 7.5660 MILES

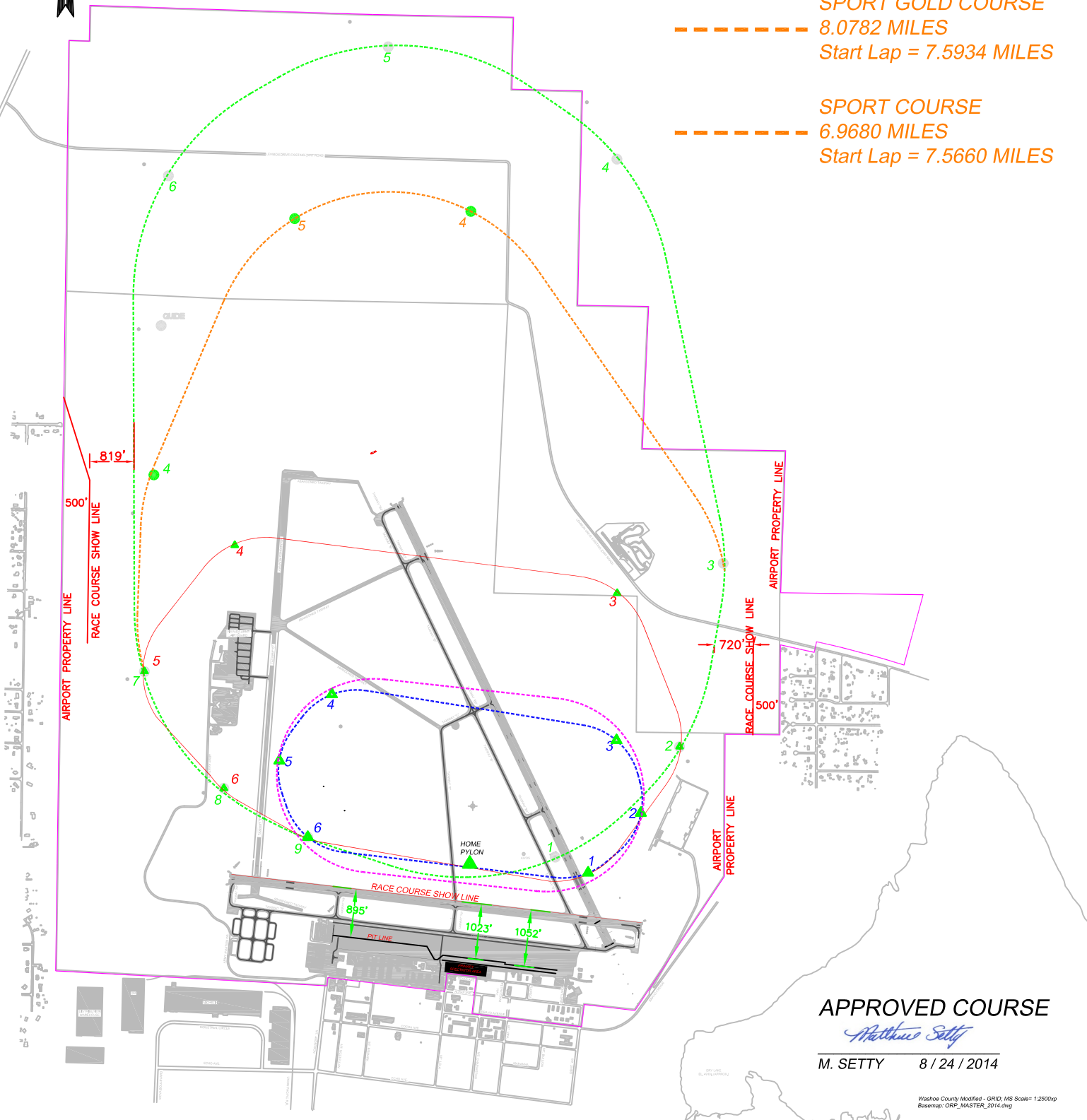

APPROVED COURSE

Matthew Setty

M. SETTY 8 / 24 / 2014