

FORMULA ONE CLASS OPTIMUM RACE PATH CRITERIA = 250 MPH @ 3.0 G's



APPROVED COPY

T.J. Gribbin
T.J. GRIBBIN 8/14/13

LEGEND

— FORMULA ONE COURSE

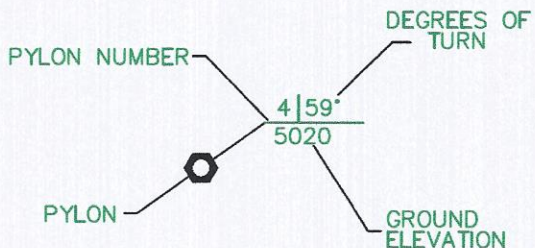

**FORMULA ONE COURSE
3.1875 MILES**

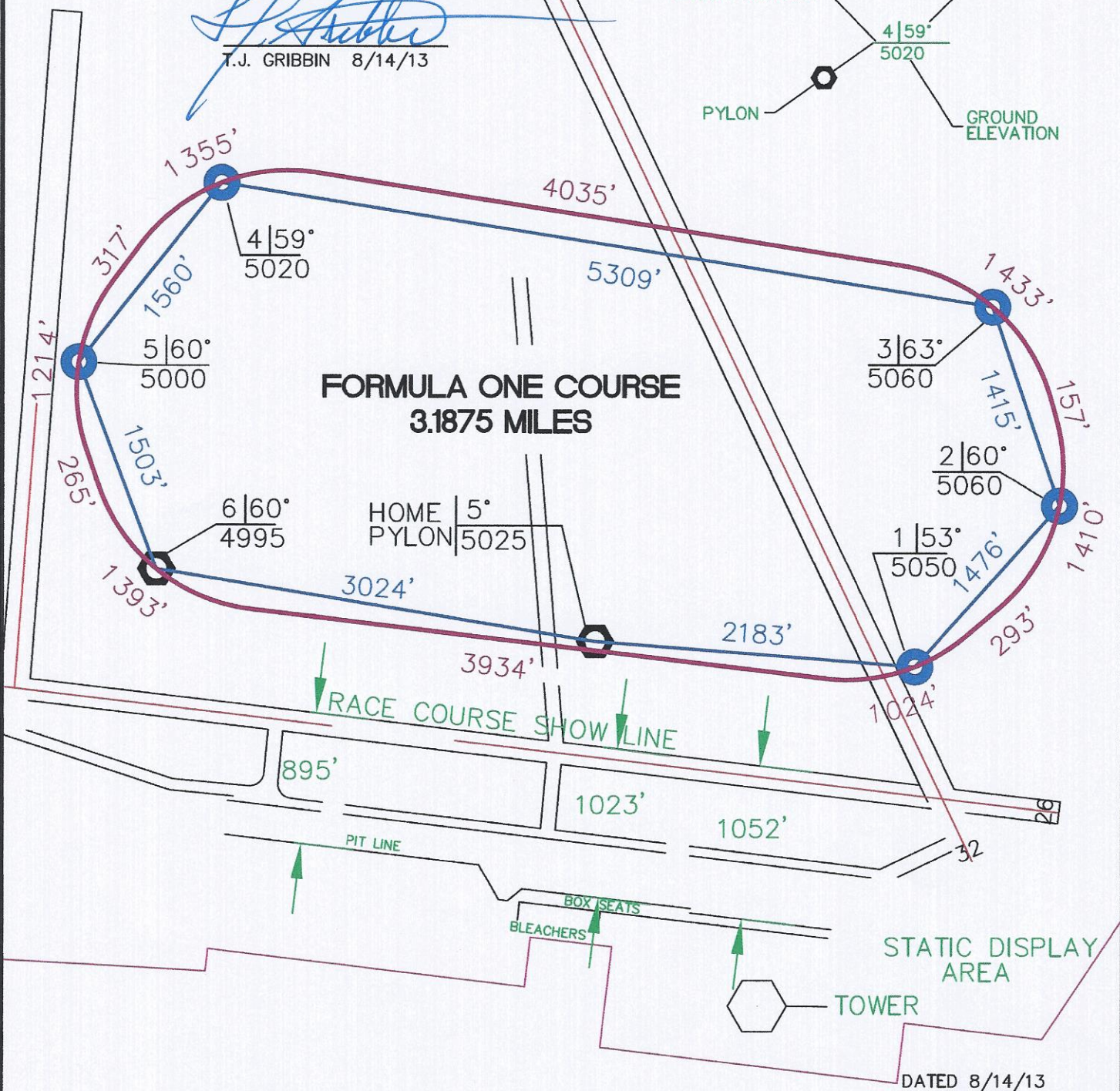

DATED 8/14/13
2012 bip f1 course.dwg

OPTIMUM RACE PATH

- T-6 COURSE
4.9657 MILES
- FORMULA ONE COURSE
3.1875 MILES
- BIPLANE COURSE
3.1761 MILES
- UNLIMITED COURSE
8.0851 MILES
START LAP - 7.5888 MI
- JET COURSE
8.1025 MILES
START LAP - 7.6113 MI.
- SPORT COURSE
6.9680 MILES
START LAP - 7.0777 MI.
- SPORT GOLD COURSE
8.0788 MILES
START LAP - 7.5938 MI.

RENO

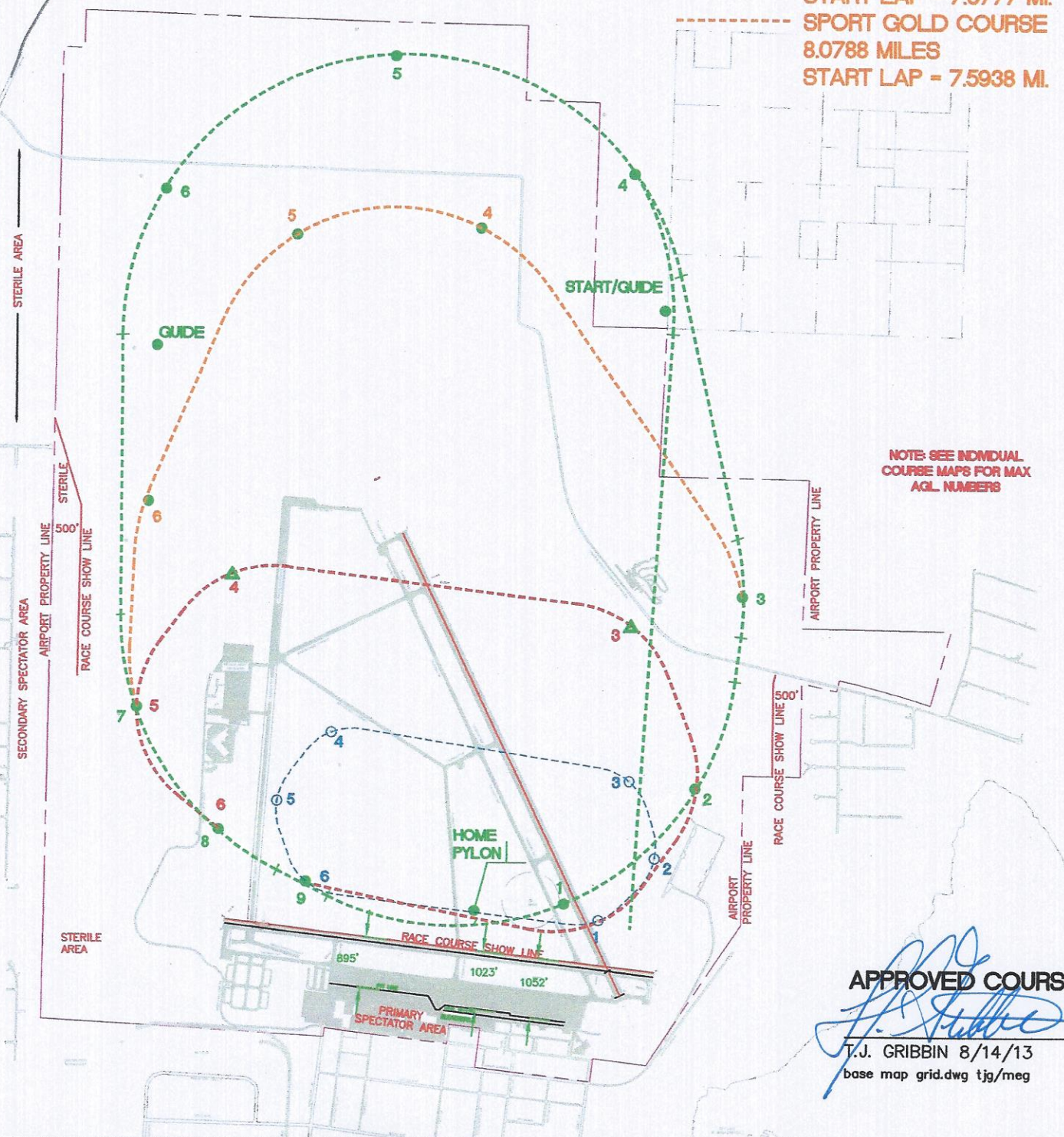

NOTE: SEE INDIVIDUAL COURSE MAPS FOR MAX AGL NUMBERS

APPROVED COURSE

T.J. Gribbin
T.J. GRIBBIN 8/14/13
base map grid.dwg tjg/meg